

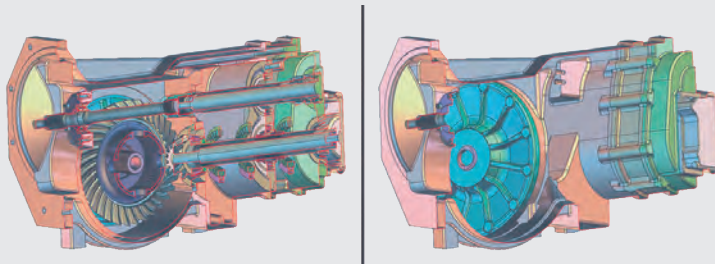

Simplification & Solid Enveloping

Not everyone needs a fully detailed model. Simplify for FEA, space claim, light-weighting and intellectual property protection.

Sometimes less is more



3D CAD models are a great design communication tool, but sometimes fully detailed models are huge in size making downstream processing quite inefficient. Simplifying 3D data by enveloping or removing features such as fillets, chamfers, holes, ribs, bosses, and more can reduce data size dramatically, making data consumption, especially in CAE analysis, straightforward.

Key Features

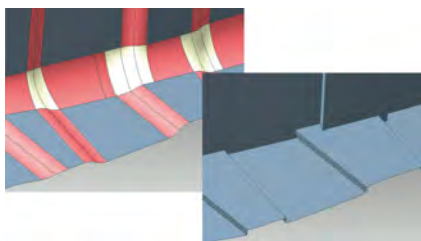

Recognizing and Removing Features

Recognize and easily remove geometric features such as fillets and chamfers without the CAD feature tree information.

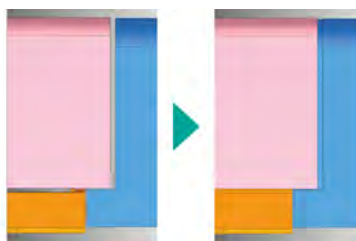

Filling Gaps between Parts

Detect and fill in minute gaps between parts in the assembly model that cannot be confirmed by the human eye.

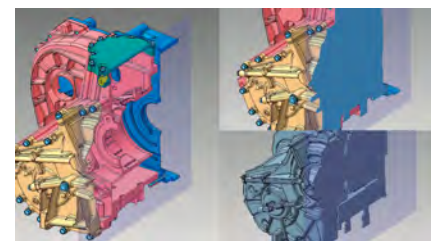

Extraction of Envelope Solid and Inner Void

Create a single lightweight solid with only the outer geometry or extract inner voids automatically from the assembly models.

Use Cases

IP PROTECTION

Your model is your intellectual property

If a model needs to be shared with customers or suppliers, 3DxSUITE's simplification solution allows you to only share what needs to be shared. Quickly remove proprietary information with confidence.

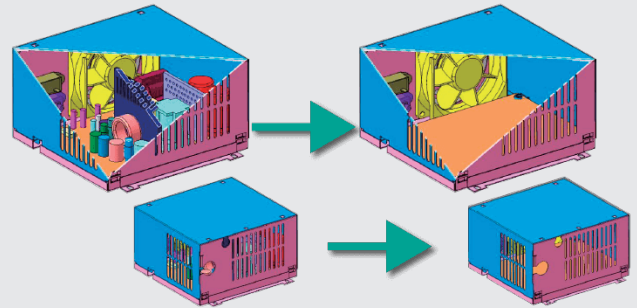

CAE ANALYSIS

CAE made simple

Improve model optimization for computer aided engineering analysis. Whether its Computational Fluid Dynamics (CFD) or structural analysis, 3DxSUITE's simplification tools are quick and effortless to get the right model for your analysis needs.

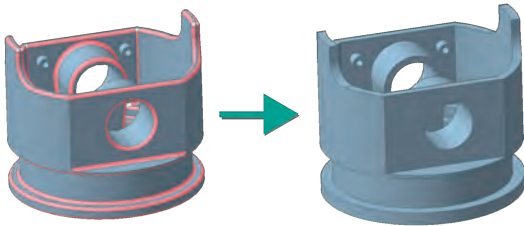

SHRINK WRAPPING

Your model in a nutshell

Simply share the outer representation of your 3D model. Only providing the crucial details without a heavy-weighted model or exposure of intellectual property.

